

New Wine Coolers  
from

**DUNAVOX**

*Touch to Open series*  
*2019*

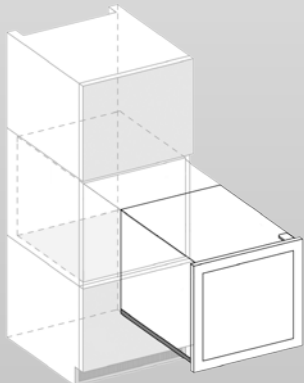
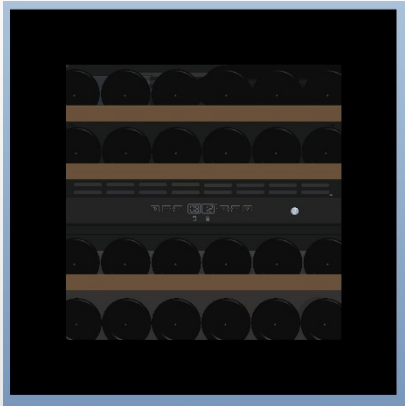

- Built-in In-column installation (Fully integrated / integrated ventilation system)
- Push-To-Open Door system without handle
- Automatic closing door
- Duo Zone, Bottle capacity: 25 bottles with 3 shelves (13+12)
- Energy Class: A
- One-piece stainless steel door or full glass door
- White/Blue LED side strip light
- Touchlight control with white/blue/red LED digital display
- No frost – Interior fan circulating
- Product dimensions (WxHxD w/o handle):  
590 x 595 x 563 / 23¼" x 23½" x 22¼"

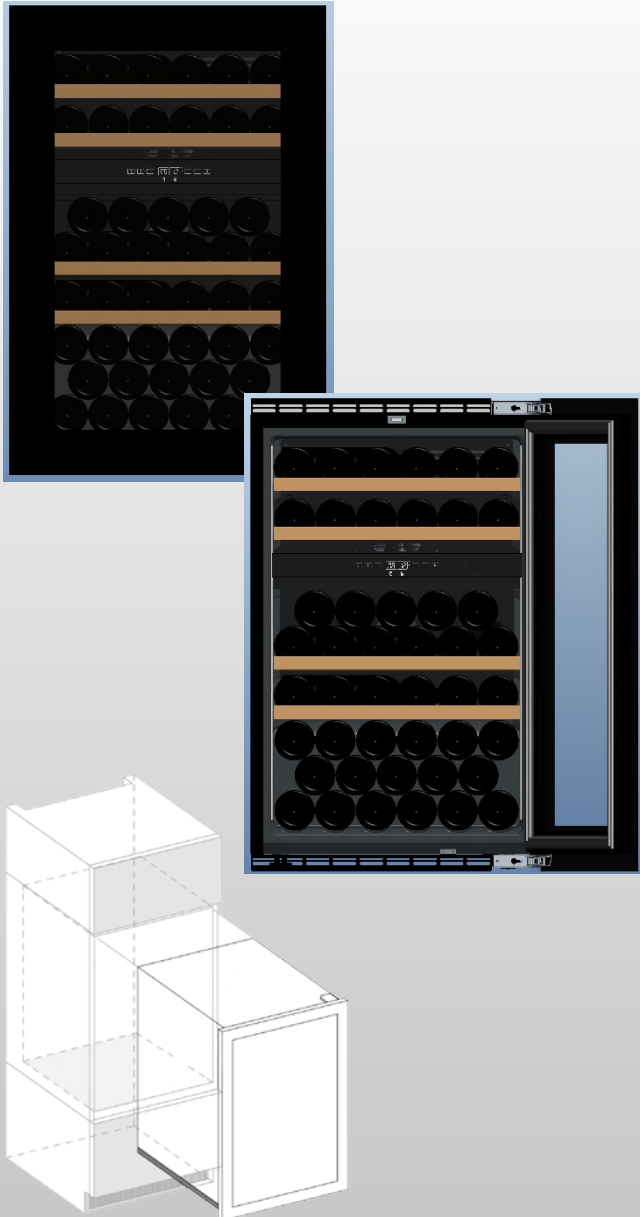

- Built-in In-column installation (Fully integrated w/ integrated ventilation system)
- Push-To-Open Door system without handle
- Automatic closing door
- Dual Zone, Bottle capacity: 49 bottles with 4 shelves (13+36)
- Energy Class: A
- One-piece stainless steel door or full glass door
- White/Blue LED side strip light
- Touchlight control with white/blue/red LED digital display
- No frost – Interior fan circulating
- Product dimensions (WxHxD w/o handle):  
590 x 885 x 563 / 23<sup>1</sup>/<sub>4</sub>" x 34<sup>7</sup>/<sub>8</sub>" x 22<sup>1</sup>/<sub>4</sub>"

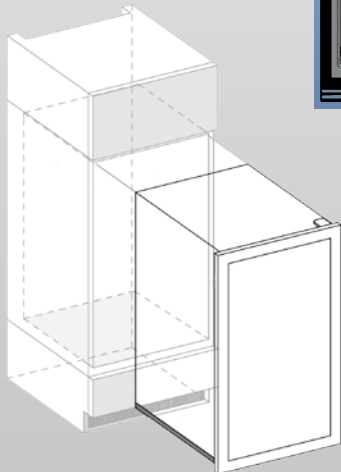
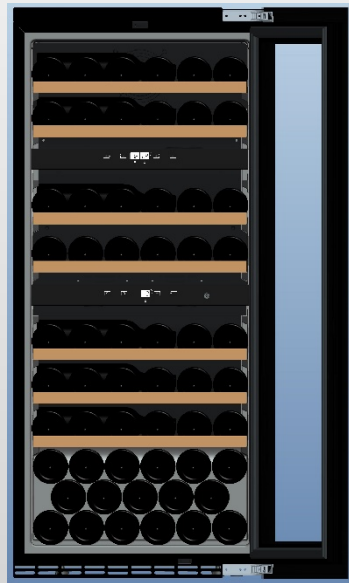
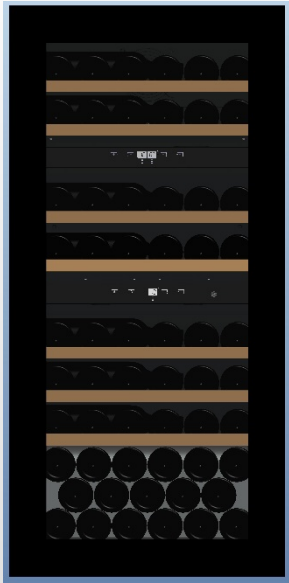

- Built-in In-column installation (Fully integrated w/ integrated ventilation system)
- Push-To-Open Door system without handle
- Automatic closing door
- Three Zone, Bottle capacity: 65 bottles with 7 shelves (14+13+38)
- Energy Class: A
- One-piece stainless steel door or full glass door,
- White/Blue LED side strip light
- Touchlight control with white/blue/red LED digital display
- No frost – Interior fan circulating
- Product dimensions (WxHxD w/o handle): 590 x 1234 x 563 / 23<sup>1</sup>/<sub>4</sub>" x 48<sup>5</sup>/<sub>8</sub>" x 22<sup>1</sup>/<sub>4</sub>"

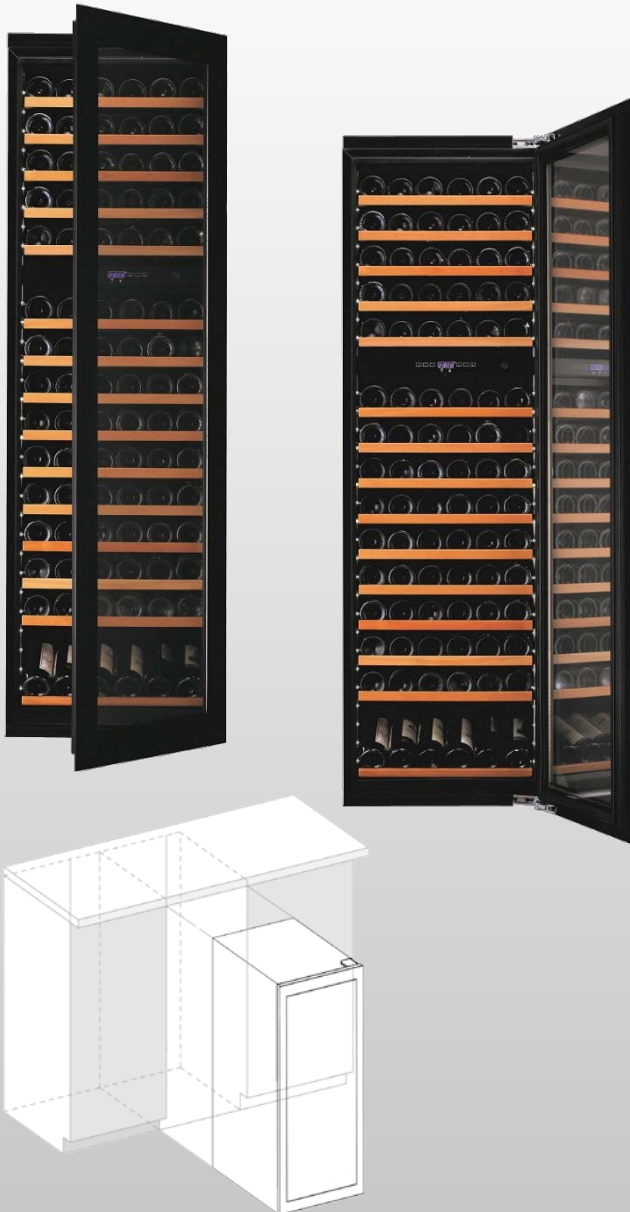

- Built-in In-column Installation (Fully integrated w/ integrated ventilation system)
- Push-To-Open Door system without handle
- Automatic closing door
- Dual Zone, Bottle capacity: 114 bottles with 15 shelves (34+80)
- Energy Class: A
- One-piece stainless steel door or full glass door
- White/Blue LED side strip light
- Touchpad control with white/blue/red LED digital display
- No frost – Interior fan circulating
- Product dimensions (WxHxD w/o handle):  
590 x 1784 x 563 / 23¼" x 70¼" x 22¼"  
Depth of Cabinet: 545 / 21½"

Expected

**Expected arrival: 2019 Q3**